

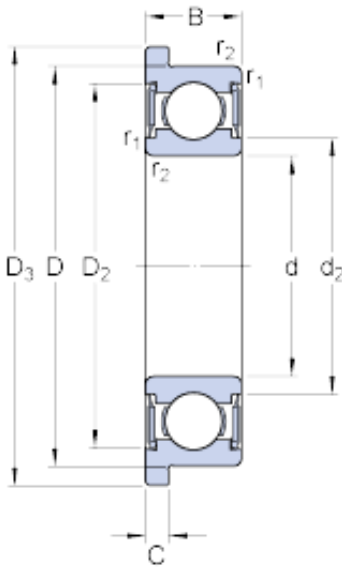

Changzhou SND bearing Co.,Ltd

8 mm x 19 mm x 6 mm SKF W 619/8 R-2RS1
deep groove ball bearings

Bearing No. W 619/8 R-2RS1



W 619/8 R-2RS1 Bearing 2D drawings and 3D CAD models

| | |
|---|-------------|
| Size | 19x8x6 mm |
| Bore Diameter | 19 mm |
| Outer Diameter | 8 mm |
| Width | 6 mm |
| d | 8 mm |
| D | 19 mm |
| B | 6 mm |
| d ₂ | 9.8 mm |
| D ₂ | 16.66 mm |
| D ₃ | 22 mm |
| C | 1.5 mm |
| r _{1,2} - min. | 0.3 mm |
| d _a - min. | 10 mm |
| r _a - max. | 0.3 mm |
| Basic dynamic load rating - C | 1.2 kN |
| Basic static load rating - C ₀ | 0.455 kN |
| Fatigue load limit - P _u | 0.02 kN |
| Limiting speed | 24000 r/min |
| Calculation factor - k _r | 0.025 |
| Calculation factor - f ₀ | 6.6 |
| d ₂ | 9.8 mm |
| D ₂ | 16.66 mm |
| D ₃ | 22 mm |
| r _{1,2} min. | 0.3 mm |



Changzhou SND bearing Co.,Ltd

| | |
|--------------------------------|-----------|
| d_a min. | 9.7 mm |
| d_a max. | 9.7 mm |
| r_a max. | 0.3 mm |
| Basic dynamic load rating C | 1.25 kN |
| Basic static load rating C_0 | 0.455 kN |
| Fatigue load limit P_u | 0.02 kN |
| Calculation factor k_r | 0.025 |
| Calculation factor f_0 | 6.6 |
| Mass bearing | 0.0079 kg |